



BEECROFT
ESTATES

41 Windmill Road

Wombwell, Barnsley, S73 8PW

Offers Over £220,000



A Fantastic Extended Three-Bedroom Semi-Detached Home on Windmill Road, Wombwell!!!!

Situated in a sought-after location on Windmill Road, Wombwell, this beautifully presented and extended three-bedroom semi-detached home offers stunning far-reaching views to the rear and a wealth of features both inside and out.

Highlights include:

A spacious extension creating a separate kitchen open-plan with the dining area – perfect for modern family living and entertaining

A larger-than-average, private rear garden with a summer house – ideal for relaxing or working from home



GROUND FLOOR

ENTRANCE HALL

Accessed via a stylish composite front door, the entrance hall features a staircase rising to the first-floor landing and a central heating radiator.

LOUNGE

A well-presented lounge featuring a front-facing double glazed window, central heating radiator, and a charming feature fire surround and hearth—adding warmth and character to the space.

DINING ROOM

A generously sized dining area offering ample space for a family dining table, complete with a useful built-in storage cupboard and central heating radiator. Open-plan to the kitchen, creating a spacious and sociable layout ideal for entertaining.

KITCHEN

Fitted with a range of modern wall and base units, complemented by worktop surfaces incorporating a sink unit with mixer tap. Integrated appliances include an oven, hob with extractor hood, washing machine, fridge, freezer, and dishwasher. A rear-facing window provides far-reaching views, adding natural light and a pleasant outlook to this well-equipped space.

FIRST FLOOR

LANDING

With a side-facing double glazed window providing natural light and access to the loft space.

BEDROOM ONE

A good-sized double bedroom featuring fitted wardrobes, a front-facing double glazed window, and a central heating radiator.

BEDROOM TWO

A further double bedroom with a rear-facing double glazed window enjoying far-reaching views, and a central heating radiator.

BEDROOM THREE

A good-sized third bedroom, currently utilised as a home office, featuring a double glazed window and central heating radiator.

BATHROOM

Fitted with a modern three-piece suite comprising a walk-in shower cubicle, WC, and wash hand basin. There is also a central heating radiator and a window with obscure glazing for privacy.

OUTSIDE

To the front of the property is a small, low-maintenance garden with a brick boundary. A shared driveway provides access to allocated parking in front of the garage.

To the rear, there is a larger-than-average garden, mainly laid to lawn, featuring a raised patio seating area—perfect for outdoor entertaining. At the bottom of the garden sits a summer house, all enjoying far-reaching views across the surrounding area.

Area Map



Floor Plans

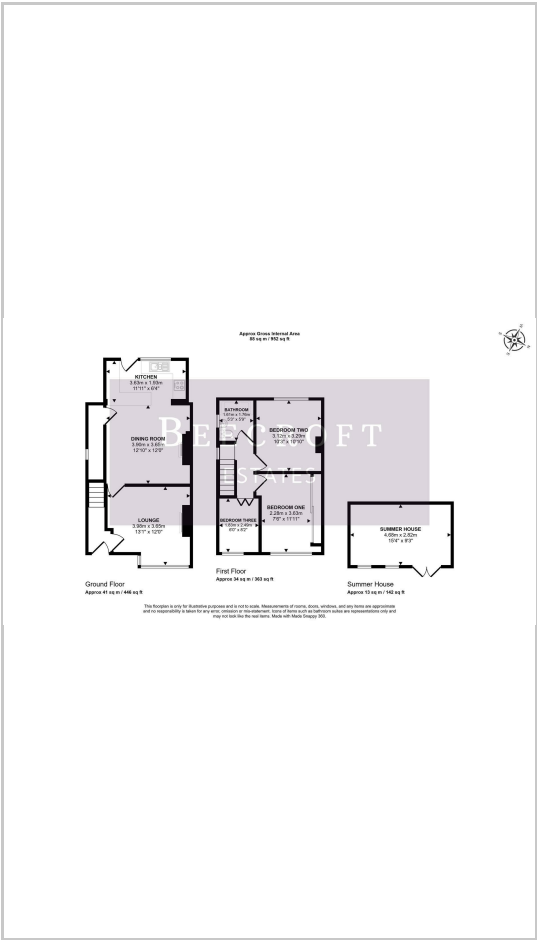

Energy Efficiency Graph

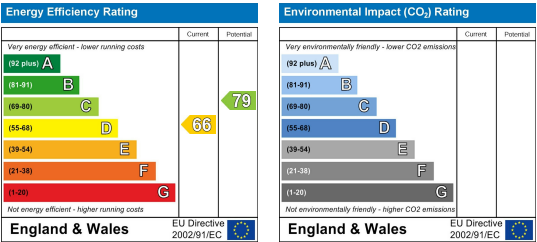

These particulars, whilst believed to be accurate are set out as a general outline only for guidance and do not constitute any part of an offer or contract. Intending purchasers should not rely on them as statements of representation of fact, but must satisfy themselves by inspection or otherwise as to their accuracy. No person in this firm's employment has the authority to make or give any representation or warranty in respect of the property.